



## USER MANUAL CHARLES



Before using this product, please read the instructions and keep it for future references.

## CONTENTS

Performance Indicators.....	1
Purifier Features.....	1
Illustration of the Product.....	3
Installation Instructions.....	4
Function Descriptions.....	6
Functions of Humidifier .....	8
Good Practices on Cleaning of Filter.....	9
Precautions.....	10
Intelligent odor sensing system.....	11
Troubleshooting.....	12

## Performance Indicators

Product Name	Air Purifier		
Purification Method	1. Cold catalyst filter, 2. Cellular activated carbon filter, 3. Anti-bacterial, 4. High efficiency HEPA, 5. UV sterilizer, 6. Negative ionizer 7. Humidifier function: High, Medium, Low		
Application Area	40 m <sup>2</sup>		
Net Weight	6.8 KG		
Air Purification Capacity	339m <sup>3</sup> /h(for PM 2.5)		
Wind Speed	High Speed : 5.8m-6.8m/s	Medium Speed : 3.5m-4.5m/s	Low Speed : 1.5m-2.5m/s
Wind Velocity	3 Speeds select High, Medium, Low		
Noise	High 55 dB	Medium 30 dB	Low 22 dB
Dimension	L360 x W195 x H565 mm		
Rated Voltage	AC 110V~120V or 220V~240V Please refer to the nameplate on the back of machine.		
Rated Total Power	65W		
Added Features	Humidifier , Intelligent Odor Sensor Control, Humidity Indicator		

## Purifier Features

### ■ Cold Catalyst Filter

1. The cold catalyst will play a catalyst effect in normal living environment without any external assistance like UV light, sunlight, high temperature or pressure.
2. It catalyzes the formaldehyde, ammonia, benzene, TVOC, hydrogen sulfide and other harmful gases to work with oxygen, and then decompose them into water and carbon dioxide.
3. The cold catalyst itself does not change during the decomposition action, thus the cold catalyst is long lasting and can be valid up to 5 years.
4. The main ingredients of the catalyst are food and medicine additives. Therefore, the product is of non-toxic, non-corrosive and non-inflammable. It works under normal condition and produces only water and carbon dioxide.
5. The cold catalyst can be used to deal with formaldehyde, ammonia, benzene, TVOC, hydrogen sulfide and other harmful gases released by plywood, furniture, wallpapers, carpets, curtains and bedspreads.

■ **Cellular-Activated Carbon Filter**

The cellular-activated carbon carries high efficient additives. It has good absorption and dust collection characteristics.

■ **Anti-bacterial Filter**

The 5-microns filter with antimicrobial agents can efficiently kill bacteria in the air.

■ **High Efficiency HEPA Filter**

The precision of the HEPA filter is 0.01-0.3 micron, and it is able to eliminate particles which are larger than 0.3 micron with the filtration rate of 99.7% or more. Dust, bacteria, fungi, viruses, allergens and other small and tiny particles are not able to get through the HEPA filter.

■ **Anion Release**

The ionizer releases large amount of anions and makes the oxygen negatively-charged, thus gathering the positively-charged particles like floating dust, bacteria, viruses and smoke. The particles become denser and sink to the ground. The smaller the particle size, the higher the capture rate.

■ **Ultraviolet Sterilize Light**

A variety of bacteria can be killed by the 365nm ultraviolet light. The UV germicidal lamp is used to purify the air and it is able to eliminate odor caused by smoke and mold. Besides, it also produces a certain amount of negative ions, which freshens the air in the room while avoiding the spreading of certain viruses.

■ **Humidifier**

The unit comes with humidification function. User may turn on the humidification function in a dry weather to:

1. Increase air humidity and improve the quality of respiration. Effectively remove the musty odor caused by smoke and mold.
2. Moisturize the skin.
3. Improve human body's metabolism, relieve tension and fatigue.

■ **Intelligent Odor Sensor System**

This unit comes with an intelligent odor sensor system . It can automatically adjust the fan speed according to the air quality display : Red(Poor), Orange(Ordinary), Green(Excellent).

**Illustration of the Product**

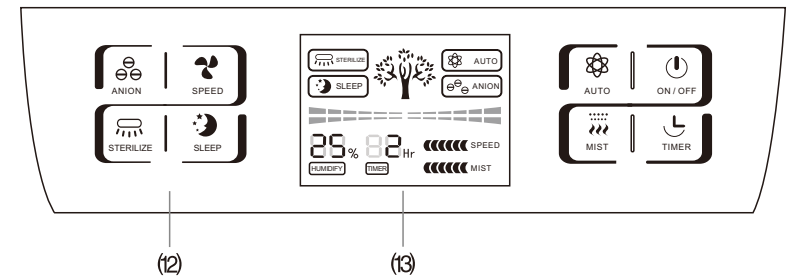
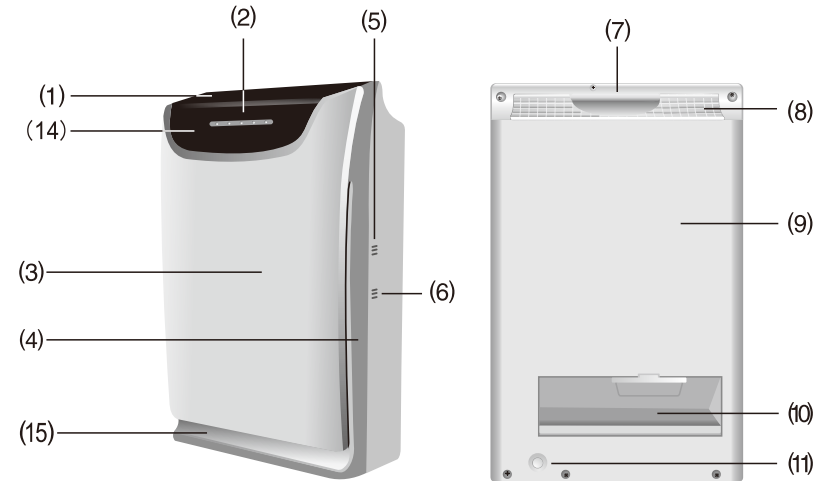

1	Control Panel	2	Quality Display Board	3	Front Plate
4	Middle Case	5	Humidity Sensor	6	Odor Sensor
7	Handle	8	Air Outlet	9	Rear Case
10	Water Tank	11	Outfalls	12	Control Button
13	Display Panel	14	Remote Control Receiver	15	Dumping Switch

## Installation Instructions

### Schematic to remove the filters

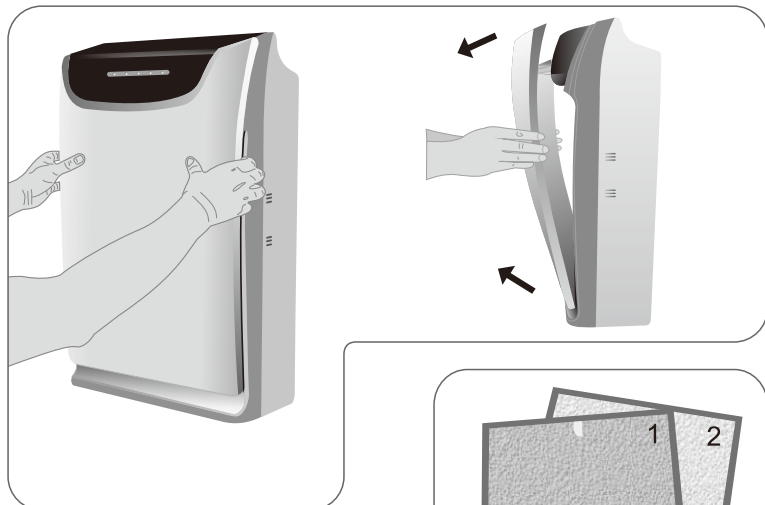

- 1 With the thumb against the front panel, right hand into the gap at the front panel of the machine connected to the hands and gently clawed front panel to open the front panel.

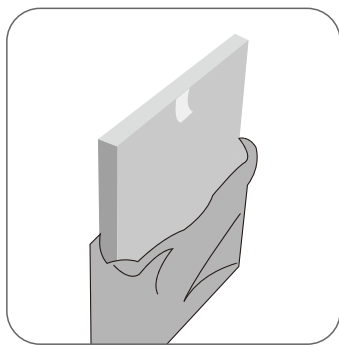

- 3 Remove all packaging bags of filter 1 and filter 2.

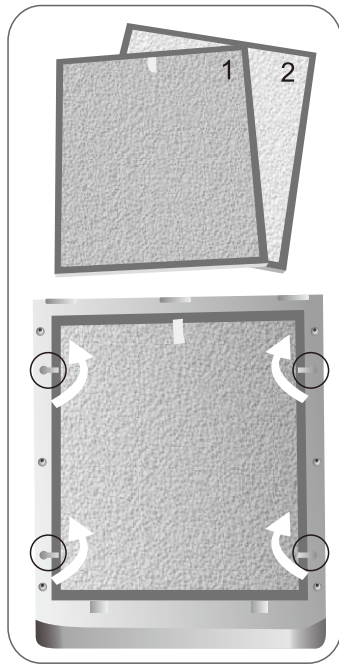

- 2 Turn the buckles as the Direction of the arrow, remove the filter 1 and filter 2 in turn.

### Schematic to install the filters



- 1 Place Filter 2 (Antimicrobial Filter and HEPA Compound Filters) back into the inner side of the product.  
Note: Ensure the tab side is facing you.

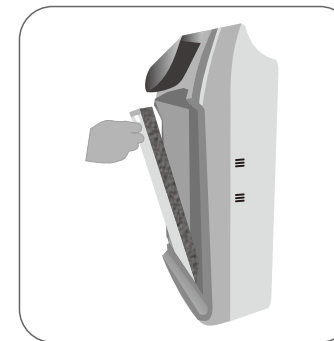

- 2 Place Filter 1 (Cold Catalyst and Activated Carbon. Compound Filters) back into the inner side of the product.  
Note: Ensure the tab side is facing you.

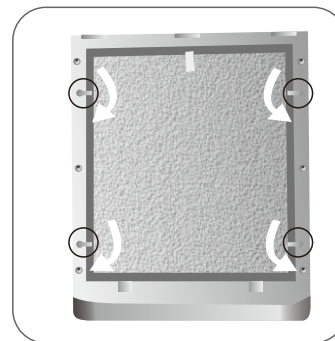

- 3 Make sure the filters are installed in position. Turn the buckles to fix the filters.

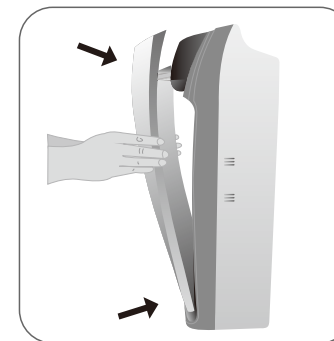

- 4 To install the front panel, place the bottom part into the host buckle and close the front panel. The front panel will be held by in-built magnets.

## Function Descriptions

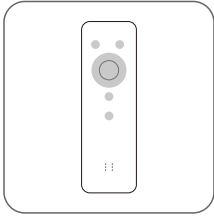

- 1** This product is equipped with a remote control that uses button cell batteries. If not using the remote control long-term, please remove batteries.

Note: the remote buttons correspond to the same buttons on the operational panel, with the same functions and operations.

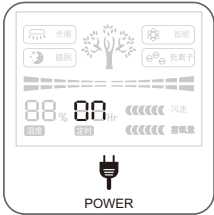

- 2** Product powered, have a buzzer sounds. The digital screen display the machine is in stand-by mode. "on".

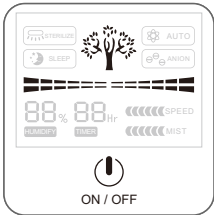

- 3** When pressing on the On/Off button, the tree design will flash in the digital screen.

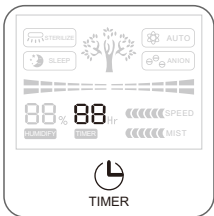

- 4** When pressing on the timer button, the machine is turned on and the intelligent odor sensor control is started, too. The machine will adjust the speed automatically according to the air quality. The timer starts from 1-12 hours. The power will be turned off when time expires.

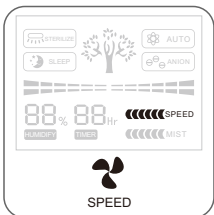

- 5** The speed control button circulates from low, medium, high and off. The speed is shown on the digital screen.



- 6** When pressing on the sleep button, the machine will be at low speed and the intelligent odor sensor control is turned off. The speed and sleep buttons are controlled in a mutually exclusive manner. When one is turned on, the other is turned off.



- 7** Press the anion button to turn on the anion generator. When it is turned on. The icon will be shown on the display screen. The intelligent odor sensor control is turned on automatically at the same time.

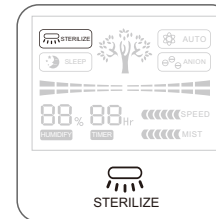

- 8** Press the sterilize button to turn on the UV germicidal light and the icon will be shown on the display screen. When it is turned on. The intelligent odor sensor control is turned on automatically at the same time.

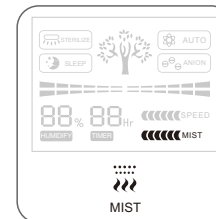

- 9** Press the Mist button to turn on the humidifier.

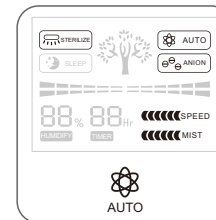

- 10** Press the AUTO button, the anion, sterilizer and wind speed and mist will turn on automatically. under Auto mode, Wind speed is automatically adjusted according to the current air quality. Mist is automatically adjusted according to the amount of current air humidity.

## Functions of Humidifier



**1** Press and hold the water tank clasp at 45° and remove the water tank.

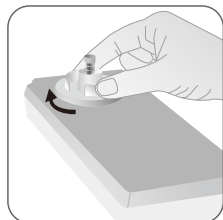
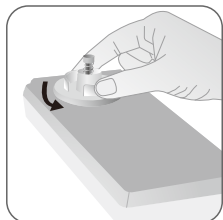

**2** Rotate the valve in an anti-clockwise manner. Remove the valve and fill the tank with water. Once finished, turn and shut the valve in a clockwise manner. (Please ensure that the rubber seal does not fall off.)



**3** Keep water tank inclined at 45° when installing it back into the machine.



**4** After the installation of the water tank, please ensure that no bubbles are generated before pressing the humidify button. You can adjust the mist amount by pressing the mist button by low, medium and high speed.



**5** When the humidifier is not in use, discharge the water from the water outlet and keep the water tank empty.

## Good Practices on Cleaning of Filter, humidifier and Anion Generator

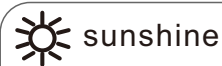

### Filter maintenance and cleaning

In order to extend the filter life, the filters should be exposed to sunlight periodically in order to release the harmful gas and odor, at the same time, to kill bacteria.

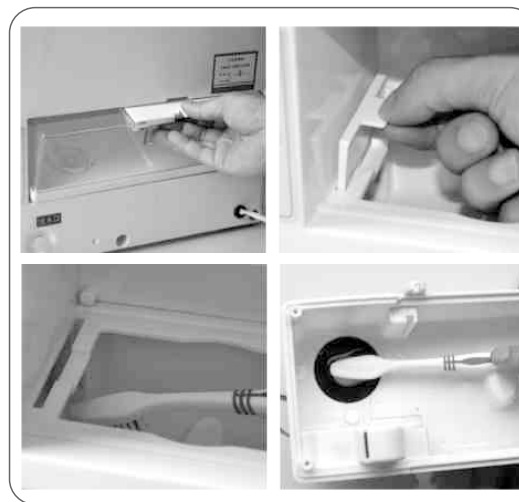

### Humidifier maintenance and cleaning

Use citric acid detergent and follow the instructions to configure solution, pour into the humidifier and soak for 10-20 minutes, then use the toothbrush or cloth to clean the humidifier, discharge the water through the outlet, and then rinse one more time.

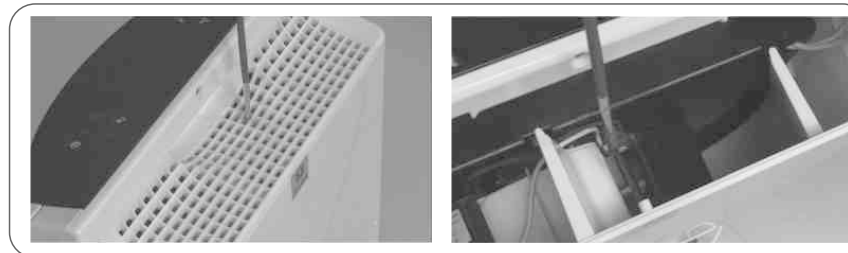

### Ionizer maintenance and cleaning

Use the Brush Pen as cleaning tool, brush tip enter from the airflow outlet on the top of anion generator Emitter, clean the dust on the emitter from each point of view.

## Precautions

### This machine is forbidden to use in the following environments

1. When use the machine, There should be a gap of at least 50cm at both sides and back of the product, while 80cm from the top surface for the Air circulation. Hanging objects may not be at the top of the machine, in order to avoid falling smashed the machine, do not put on uneven ground used to prevent breaking the machine.
2. Please do not put this machine next to curtains and furniture so as not to affect the machine performance.
3. Do not use this machine in a humid or high temperature environment.
4. Do not use this product near gas appliances, heating devices or near stove.
5. This machine is suitable for temperature 5-40 °, non-water shower machine; this machine is only for indoor use.

### Warning and notice

1. Before you move the machine, please cut off the power supply.
2. For safety please do not allow children or the disabled to handle the equipment unsupervised, Remote control not play for children, so as to avoid remote control failure.
3. Before using the machine need to first check the power cord and plug are damaged, do not bend or pull the power cord, power cord, and power cable; do not arbitrarily change so as not to loose contact or an electric shock hazard.
4. Do not use wet hand to plug power plug, make sure the local power supply voltage is the same as indicated on the nameplate on the back of machine.
5. If the machine has trouble, In order to avoid danger, do not secretly teardown inspection or maintenance, please discontinue the use of the product and contact an authorized agent to fix it.
6. This machine shall not be used with a program controller, a timer or any other automatic switching device used, so as to avoid damage to the machine or accidents.
7. Absolutely prohibition using hands or other small objects inserted in machine slot or hole inside of the fuselage (such as vents, air outlet), to avoid accidents.
8. Do not sum game inlet and outlet, for example, do not place objects in front of the outlet or inlet.
9. This product is not supposed to be used as daily ventilator, dust cleaner or cooker hood.

10. If the water tank leaks, turn off the power and put the product in an upright position for 30 minutes before use.
11. Note often clean odor sensor area and humidity sensor area to prevent betting and affect the efficiency.
12. Do not use this product near gas appliances, heating devices or near stove.
13. Please unplug the socket after use and before cleaning.
14. Please do not use this machine under temperature changes in the larger environment, lest we might create condensation water droplets within the product.

## Intelligent odor sensing system memory reset instructions

### Memory reset as follows:

If the air quality indicator displays red light and the machine power is cut off suddenly, you may have to reset the intelligent memory. Otherwise, the red light display will remain.  
Long press the sleep button until hear the buzzer sounded "drop by drop" sound when air quality indicator light starts blinking, flashing end into a functional State.

### Precautions

1. When the machine work on memory reset function, pls make sure under the no pollution environment.
2. If the memory reset function used under pollution environment, the display light would be go wrong.

## Troubleshooting

### When the filter system with full load must be cleaned or replaced

Problem	Solution
No air comes out from the outlet	Please check whether the product is turned on and connected to the power supply.
Outlet airflow is significantly weakened than before	The filters are dirty and they need to be cleaned or replaced. You can slightly shake the filters to remove the dust and other objects on it.
	The filter packaging bag is not removed. Please remove the filter packaging bag.
The air quality is not significantly improved after long run of the machine	Check the filter layers installation sequence.
	Filters are worn out, you need to replace all the filters.
When should I replace the filters	The first filter: The surface is dirty and fades in color. The tiny hole of the cold catalyst is blocked by dust or the color of the active carbon has obviously changed. Life time: 8-14 months.
	The second filter: The white HEPA changes to yellow, black, or mildew. Life time: 8-14 months.
	Remarks: The filter life span is determined by the environment air quality and the duration used.
Alarm is Generated	Check if the water tank is empty.
Powered Down	Check if the anti-fall off switch is properly switched off.